



Since 1949

Acme Sanitary Ware Co. Ltd.

1/F, Acme Building, 22-28 Nanking Street, Kowloon, Hong Kong

Tel: 2388 7171 Fax: 2710 8012

Email: acme@acmesanitary.com.hk



Website: www.acmesanitary.com.hk

GROHE
PROFESSIONAL

WORK
SMARTER

PROJECT		REF		REV	ITEM CODE	
LOCATION		DATE			LEGEND	

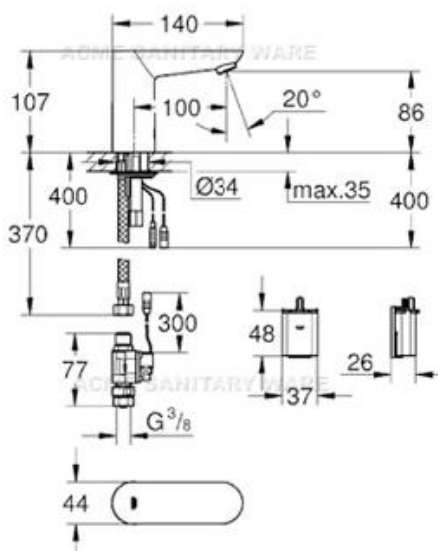
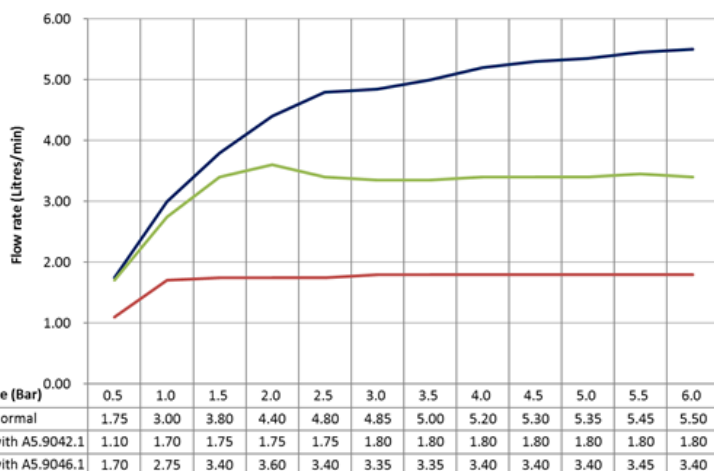
SANITARY WARE SPECIFICATION SHEET

Item Descriptions	GROHE (Germany) "Euroeco Cosmopolitan E" Infra-red electronic basin tap 1/2" in DC Supply; nominated flow rate 1.8 L/min in WELS Grade 1; Registration No. TN 18-0007	Illustration/ Drawing																																																				
Dimensions	L140 x W44 x H107 mm																																																					
Model	36271000 (Tap) A5.9042.1 (Aerator)																																																					
Finish	Chrome Plated																																																					
Manufacturer	GROHE Limited																																																					
Supplier	Acme Sanitary Ware Co. Ltd Mr. Eric Wong/ Mr. Don Yuen																																																					
Contact Tel/Fax	(852) 2388-7171 / (852) 2710-8012																																																					
E-mail	acme@acmesanitary.com.hk																																																					
Website	www.acmesanitary.com.hk																																																					
Euroeco Cosmopolitan E Infra-red electronic basin tap without mixing device with infrared sensor for bi-directional communication for monitoring, configuration and service purpose for cold or premixed water 6 V lithium-battery, type CR-P2 battery lifetime: approx. 7 years (150 actuations a day) GROHE StarLight finish GROHE EcoJoy mousseur 5.7 l/min flexible connection hoses dirt strainers external solenoid valve			external battery rapid installation system multistage battery status display 7 pre-set programs: auto flush thermal disinfection cleaning mode additional functions and precise settings by remote control 36 407 CE approved acoustic group I in accordance with DIN 4109 type of protection faucet IP 59K min. recommended pressure 1.0 bar Sensor range: 7-20 cm adjustable Type of fitting protection: IP 59																																																			
																																																						
<table><thead><tr><th>Dynamic Pressure (Bar)</th><th>0.5</th><th>1.0</th><th>1.5</th><th>2.0</th><th>2.5</th><th>3.0</th><th>3.5</th><th>4.0</th><th>4.5</th><th>5.0</th><th>5.5</th><th>6.0</th></tr></thead><tbody><tr><td>Normal</td><td>1.75</td><td>3.00</td><td>3.80</td><td>4.40</td><td>4.80</td><td>4.85</td><td>5.00</td><td>5.20</td><td>5.30</td><td>5.35</td><td>5.45</td><td>5.50</td></tr><tr><td>with A5.9042.1</td><td>1.10</td><td>1.70</td><td>1.75</td><td>1.75</td><td>1.75</td><td>1.80</td><td>1.80</td><td>1.80</td><td>1.80</td><td>1.80</td><td>1.80</td><td>1.80</td></tr><tr><td>with A5.9046.1</td><td>1.70</td><td>2.75</td><td>3.40</td><td>3.60</td><td>3.40</td><td>3.35</td><td>3.35</td><td>3.40</td><td>3.40</td><td>3.40</td><td>3.45</td><td>3.40</td></tr></tbody></table>		Dynamic Pressure (Bar)		0.5	1.0	1.5	2.0	2.5	3.0	3.5	4.0	4.5	5.0	5.5	6.0	Normal	1.75	3.00	3.80	4.40	4.80	4.85	5.00	5.20	5.30	5.35	5.45	5.50	with A5.9042.1	1.10	1.70	1.75	1.75	1.75	1.80	1.80	1.80	1.80	1.80	1.80	1.80	with A5.9046.1	1.70	2.75	3.40	3.60	3.40	3.35	3.35	3.40	3.40	3.40	3.45	3.40
Dynamic Pressure (Bar)	0.5	1.0		1.5	2.0	2.5	3.0	3.5	4.0	4.5	5.0	5.5	6.0																																									
Normal	1.75	3.00		3.80	4.40	4.80	4.85	5.00	5.20	5.30	5.35	5.45	5.50																																									
with A5.9042.1	1.10	1.70		1.75	1.75	1.75	1.80	1.80	1.80	1.80	1.80	1.80	1.80																																									
with A5.9046.1	1.70	2.75	3.40	3.60	3.40	3.35	3.35	3.40	3.40	3.40	3.45	3.40																																										

* All information of the above is for the reference only. No prior notice is made if any changes.



Since 1949

Acme Sanitary Ware Co. Ltd.

1/F, Acme Building, 22-28 Nanking Street, Kowloon, Hong Kong

Tel: 2388 7171 Fax: 2710 8012

Email: acme@acmesanitary.com.hk

Website: www.acmesanitary.com.hk



WORK
SMARTER

PROJECT		REF		REV	ITEM CODE	
LOCATION		DATE			LEGEND	

SANITARY WARE SPECIFICATION SHEET

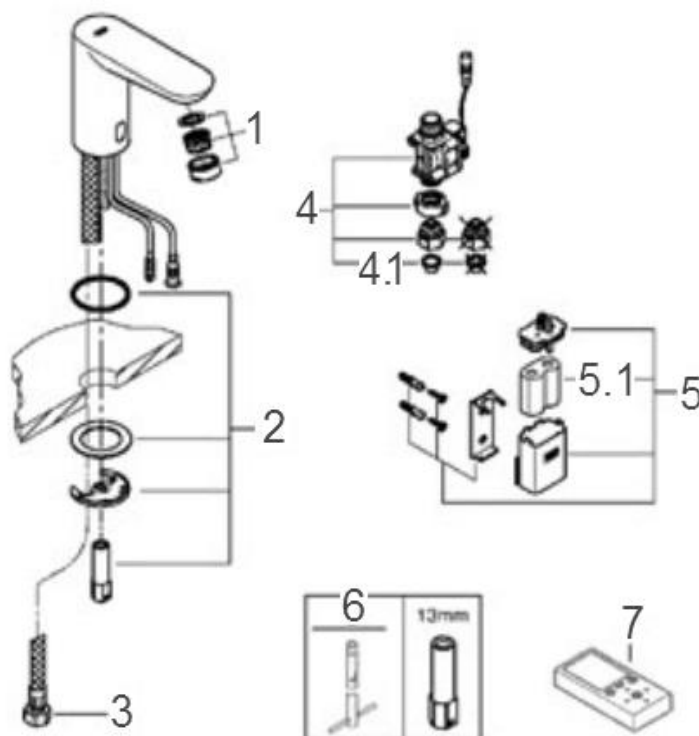

1	Economy flow control (M 22 x 1)	13951 000
2	Shank mounting kit	42389 000
3	Connection tube	42391 000
4	Solenoid valve	42390 000
4.1	Dirt strainer	42395 000
5	Battery housing	42393 000
5.1	Battery	42886 000
Special Accessoires:		
6	Mounting wrench	19017 000
7	Power supply switch	36338 000

註冊號碼 (Registration No.): TN 18-0007



自願參與用水效益標籤計劃 - 水龍頭
Voluntary Water Efficiency Labelling Scheme - Water Taps



註冊證書



茲證明

This is to certify that

將下列水龍頭在本計劃內註冊:

has registered the following water tap under this scheme:

牌子 / Brand	:	GROHE
型號 / Model	:	36271000 + A5.9042.1
種類 / Type	:	Non-mixing
原產地 / Country or Region Origin	:	Germany

在用水效益標籤上展示的標誌

Symbolic Presentation on the Water Efficiency Label



滴水點

Water droplet(s)

用水效益級別

Water Efficiency Grade

:

1

with additional merit*

耗水量

Water Consumption

:

1.8

公升/分鐘

litres/minute

*with additional merit of "Automatic closing mechanism"

簽發日期: 9 February 2018
Date of Issue:



水務署
Water Supplies Department



水務署署長(周世威代行)
for Director of Water Supplies



水務署
Water Supplies Department

總部 Headquarters

香港灣仔告士打道七號入境事務大樓 48 樓

7 Gloucester Road, Wan Chai, Hong Kong



本署檔號
Our ref.
來函檔號
Your ref.

9 T/J(1183/2019)

電話 :
Tel.
傳真 : 2824 0578
Fax.

9 March 2020



**Approval of "GROHE" Sensor Tap
(General Acceptance No. C20200138)**

Your letters ref. WRC/2127 and C-WSD/0560 dated 18 December 2019 and 23 January 2020 respectively refer.

Having considered the test reports ref. J24279Arl and J24474 issued on 17 January 2020 and 23 October 2019 by Nutek Systems (HK) Ltd., this Authority accepts that the fitting described below complies with, and its use when correctly installed does not contravene, the Waterworks Ordinance and Regulations.

Name of Manufacturer: Grohe AG

Country of Origin: Germany

Brand: Grohe

Details of Fitting: 3/8" Infrared electronic basin tap with 1 no. of flexible hose

Model: 36271XXX
(where the digits "XXX" denote the code of colour)

Body Markings: 



Expiry Date: 16 June 2024

This Authority hereby permits the use of the above fitting in fresh water plumbing systems subject to full adherence to Waterworks installation requirements. In particular, you are required to draw your customers' attention to the following requirement-

"A stop cock or gate valve must be installed at the upstream of the fitting for manual isolation of water supply." AND

"The main voltage operated sensor valve should comply with the electricity safety regulation for applications in bathroom, toilet etc."

A condition of this acceptance is that the fitting to be installed shall be replicas of the sample as certified by the testing agent mentioned above and without modifications. This acceptance may be withdrawn at any time if the standard of the fitting installed fail to meet that of the approved sample or if the fitting is found to be unsuitable for use in fresh water plumbing systems.

This acceptance is only applicable to the main body of the fitting, unless otherwise specified.

For the use of the fitting in any project, the General Acceptance Number of this letter must be quoted as a means of identification of acceptance of the fitting by this Authority.

Should you have any enquiries, please contact our Engineer Mr. Terry KUNG at tel. no. 3583 4086.

Yours faithfully,



(CHAN Chung-kun)

for Director of Water Supplies

Encl.

c.c. WSD 3321/1/82] - without catalogue
 ME/MC] - with soft copy only



水務署
Water Supplies Department

總部 Headquarters

香港灣仔告士打道七號入境事務大樓 48 樓

48/F, Immigration Tower, 7 Gloucester Road, Wan Chai, Hong Kong



3321/2020 T/J(17/2020)

電話

Tel.

傳真

Fax.

2824 0578

17 March 2020



(413555040)

Approval of "GROHE" Flexible Hoses
(General Acceptance No. C20200161)

Your letters ref. WRC/2134 and C-WSD/0571 dated 6 January 2020 and 25 February 2020 respectively refer.

Brand	Model No.	Nutek Test Report Ref.	Issuance Date
Grohe	413555040	J24474r1	4 Feb 2020
Grohe	413556040	J24474-1r1	4 Feb 2020
Grohe	413554040	J24474-2r1	4 Feb 2020
Grohe	413557040	J24474-3r1	4 Feb 2020
Grohe	413558040	J24474-4r1	4 Feb 2020

Having considered the above test reports issued by the Nutek Systems (HK) Limited, this Authority accepts that the fittings described below comply with, and their use when correctly installed does not contravene, the Waterworks Ordinance and Regulations.

Name of Manufacturer: Grohe AG

Country of Origin: Germany

Brand: Grohe

Details of Fitting: Polyamide braided inlet flexible hose for tap/mixer



Model: 413554040, 413555040, 413556040, 413557040,
413558040

Size: Bore diameter: 6mm
End connection: 3/8"

Body Markings:  

Expiry Date: 12 September 2024

This Authority hereby permits the use of the above fittings in fresh water plumbing systems subject to full adherence to Waterworks installation requirements. In particular, you are required to draw your customers' attention to the following requirement-

"The inlet flexible hoses are applied for the water tap or mixer connection only and installed in the fresh water plumbing systems."

A condition of this acceptance is that the fittings to be installed shall be replicas of the samples as certified by the testing agent mentioned above and without modifications. This acceptance may be withdrawn at any time if the standard of the fittings installed fails to meet that of the approved samples or if the fittings are found to be unsuitable for use in fresh water plumbing systems.

For the use of the fittings in any project, the General Acceptance Number of this letter must be quoted as a means of identification of acceptance of the fittings by this Authority.

Should you have any enquiries, please contact our Engineer Mr. Terry KUNG at tel. no. 3583 4086.

Yours faithfully,

(CHAN Chung-kun)

for Director of Water Supplies

Encl.

c.c. WSD 3321/1/82] - without catalogue
ME/MC] - with soft copy only